

Original

**EXTI-SHELTER**®

to Serve and to Protect



- EXTI-SHELTER** - is made to protect your extinguisher against crush and fire
- keeps your extinguisher proper and ready for use
  - is fire-proof
  - is break-proof
  - is easy to mount

- EXTI-SHELTER 9-12 ec L** - for extinguisher (Volume 9 to 12 liter)
- carbon dioxide -  
(eccentric shape to place the horn)

- contents: **EXTI-SHELTER 9-12 ec L**
- EXTI-SHELTER base plate
  - 2 screws (stainless steel)
  - 2 plastic dowels (to drill  $\phi$  8,0 mm)
  - without extinguisher

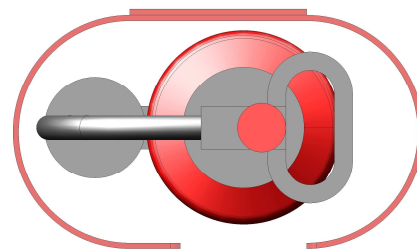
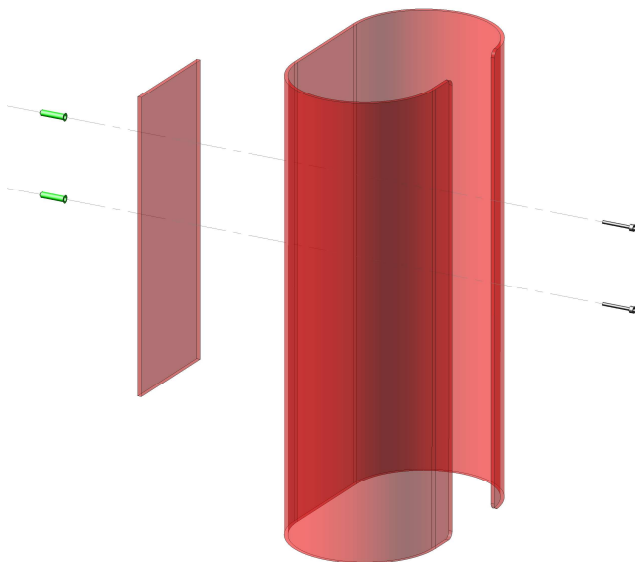

- size: 400 x 220 x 700 mm

*take measurements of your extinguisher to find hole-position*